

<b>DALI</b>	Standards:	EN 61547
		EN 61347-1
		EN 61347-2-11
		EN 55015

**Product Image**

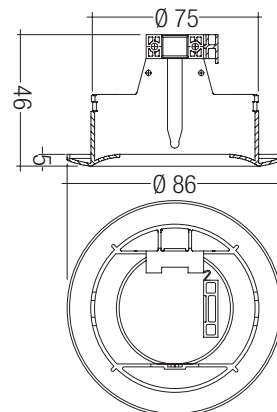

**Dimensions**



**Coverage**

**Light level**

**PIR Detector**

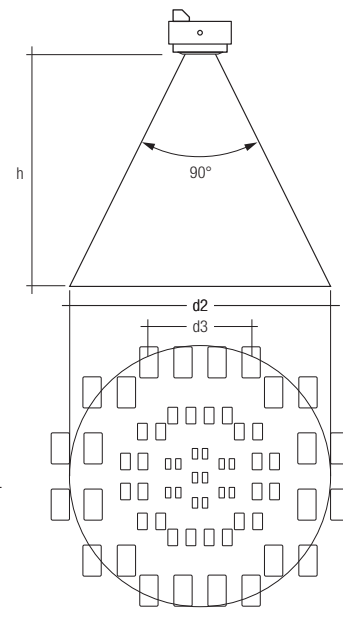
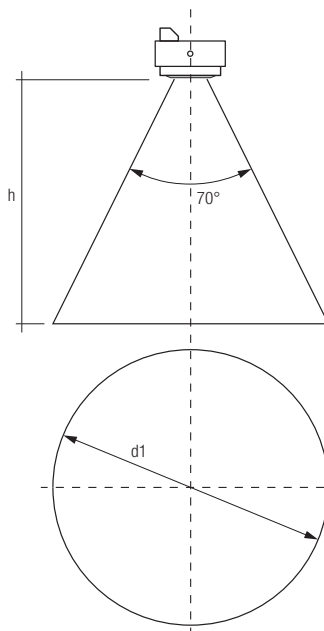

**Functions**

- Presence / Absence Detection
- High sensitivity PIR
- Constant (Daylight) regulation

**Convenience**

- Available with pre-wired plug and lead for LCM

**Compatible Systems**

Class Control	No
Control 2	No
Control 2+	No
Control 3	Yes

**Basic Technical Data**

Power Source	Bus Supplied
DALI Current Draw	10mA
Weight	54g-109g
Interface	DALI (Single Address)

h	d1	d2	d3
1.7m	2.4m	3.4m	1.36m
2.0m	2.8m	4.0m	1.6m
2.3m	3.2m	4.6m	1.84m
2.5m	3.5m	5.0m	2.0m
2.7m	3.8m	5.4m	-
3.0m	4.2m	6.0m	-
3.5m	4.9m	7.0m	-
4.0m	5.6m	8.0m	-

h=mounting height  
 d1=lightlevel recognition area  
 d2=movement detection area  
 d3=small movement detection area

**Part Numbers**

**Description**

97-MSENSOR-02-5DPI-41F	Combined DALI Multisensor for installation integral to luminaire
97-MSENSOR-02-5DPI-41RC	Combined DALI Multisensor for recessed ceiling installation
97-MSENSOR-02-5DPI-41RC-MCC3P-5M	Combined DALI Multisensor for recessed ceiling installation with pre-fitted 5m plug and lead for MCC10B LCM
97-MSENSOR-02-5DPI-41W	Combined DALI Multisensor for wall box mounting
97-MSENSOR-02-5DPI-41RS	Combined DALI Multisensor for surface mounting